

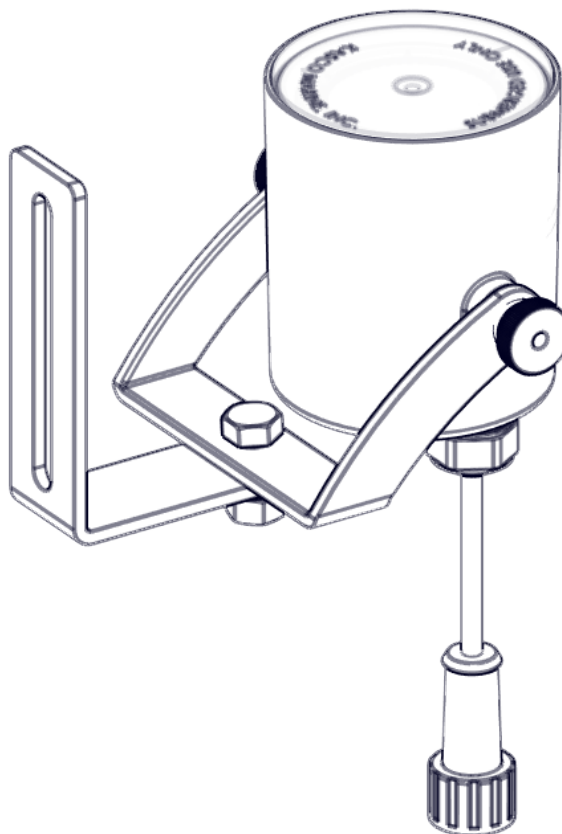

MOVING WATER FORWARD, SINCE 1968

RGB4C5

Universal Composite WaterGlow Lighting



Operation & Maintenance Manual

Document number 884103
Document version 2021.2.0

800 Deere Rd. Prescott, WI 54021 | 715.262.4488 | sales@kascomarine.com | kascomarine.com

TABLE OF CONTENTS

Safety First2

Parts Included3

Universal Mounting Instructions4

Control Panel Installation & Operation6

Control Input Features7

Maintenance Recommendations.....8

Warranty9

Repair9

Non-Warranty Repairs10

Repair Contact Form11

QUESTIONS?

 715.262.4488

 kascomarine.com | sales@kascomarine.com

SAFETY FIRST

Please read and follow these important instructions to help ensure your safety and the quality performance of your Kasco equipment.

- RGBC5 kit is 120Vac and **MUST** be plugged into a GFCI protected receptacle or GFCI protected field terminal connections.
- RGBC5 fixtures **MUST** be properly submerged (approximately halfway) to avoid overheating; **insufficient submersion or operation out of water will damage fixtures and void warranty.**
- Use caution when dealing with any electrical and/or moving equipment.
- **Under NO CIRCUMSTANCES should anyone enter the water with the electrical equipment plugged in and/or in operation.**
- Kasco WaterGlow lighting kits are intended for use with a Listed control panel having a GFCI protected receptacle, or field wiring terminals and disconnect switch, or a timer with a disconnect for use with a GFCI receptacle. They are intended to be mounted on a floating fountain or aerator for use in a natural or man-made body of water to comply with NEC Article 682.
- Kasco WaterGlow lighting kits have not been evaluated for use in swimming pools, spas or stationary fountains.
- Use extreme caution around water, especially cold water, as in spring, fall, and winter, which poses a hazard in and of itself.
- NEVER lift or drag the equipment by the power cords. If you need to pull the unit to the side of the pond, use the anchoring ropes.
- Do not use boats that tip easily for lighting kit installation and follow all boating safety rules and regulations, including wearing a PFD (Personal Flotation Device). Do not use waders in deep ponds/lakes or ponds/lakes with drop-offs, drastic slopes, or soft bottom material.
- For more information regarding your control panel instructions, refer to your equipment owner's manual. A control panel must be installed a minimum of 5 feet (3m in Canada) from the body of water unless separated from the body of water by a fence, wall, or other permanent barrier that will make the unit inaccessible to persons in the water. A complete list of control panels can be found in the Accessories section of kascomarine.com.
- **Warning:** When using the universal mounting bracket assembly, ensure the WaterGlow fixtures are mounted properly to provide cooling of the fixture. Typically, the bottom half of the fixture should be submerged. Recheck the fixture elevation with the fountain/aerator in operation. Assembly to your fountain/aerator float will be as illustrated on the next page. Make adjustment to the fixture elevation to ensure the fixture is properly submerged when the fountain/aerator is in operation.
- Many fountain/aerator floats will drop lower in the water when running.

PARTS INCLUDED

ID	Description	Qty	Part No.
A	RGBC5 Fixture	4	347000
B	Cord connector O-ring	4	345035
C	10-32 thumb nut	8	345043
D	#10 split lock washer	8	771037
E	Bracket O-ring	8	345008
F	Composite light bracket	4	345007
G	10-32 x 1/2" hex screw	8	345042
H	1/4"-20 x 1-3/8" hex screw	4	584692
I	1/4", 5/8 O.D. flat washer	4	258476
J	1/4"-20 split lock washer	12	840537
K	1/4"-20 nut	8	840536
L	Cable tie (not shown)	8	415038
M	RGB Control panel (not shown)	1	130030
Universal Mounting Hardware			
N	Universal mounting bracket	4	345060
O	1/4"-20 x 3/4" hex screw	4	840539
P	1/4" fender washer	4	144114
Q	1/4"-20 x 2-1/2" hex screw	4	345048

Universal Mounting Hardware

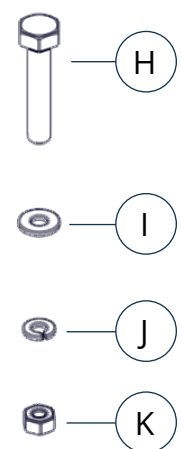
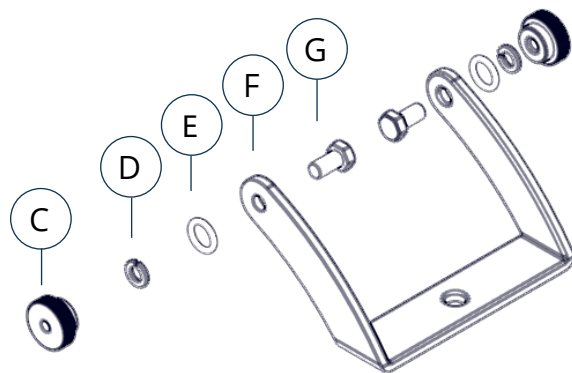
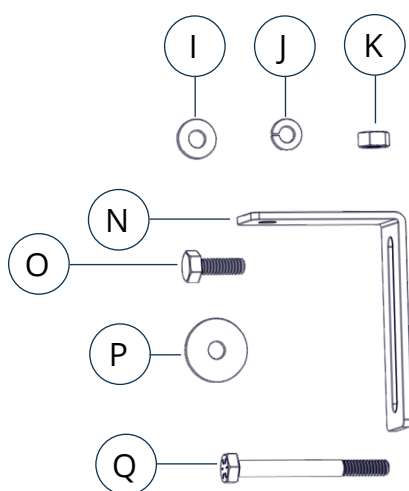

UNIVERSAL MOUNTING INSTRUCTIONS

1. Attach the bracket (F) to the light fixture (A) by fitting the head of the 10-32 x 1/2" hex screw (G) into the tabs on each side of the fixture. Place one bracket O-ring (E), one #10 lock washer (D), and one thumb nut (C) on each #10 screw outside the bracket. Tighten the thumb screws on each side hand tight only. Repeat this step for all fixtures.

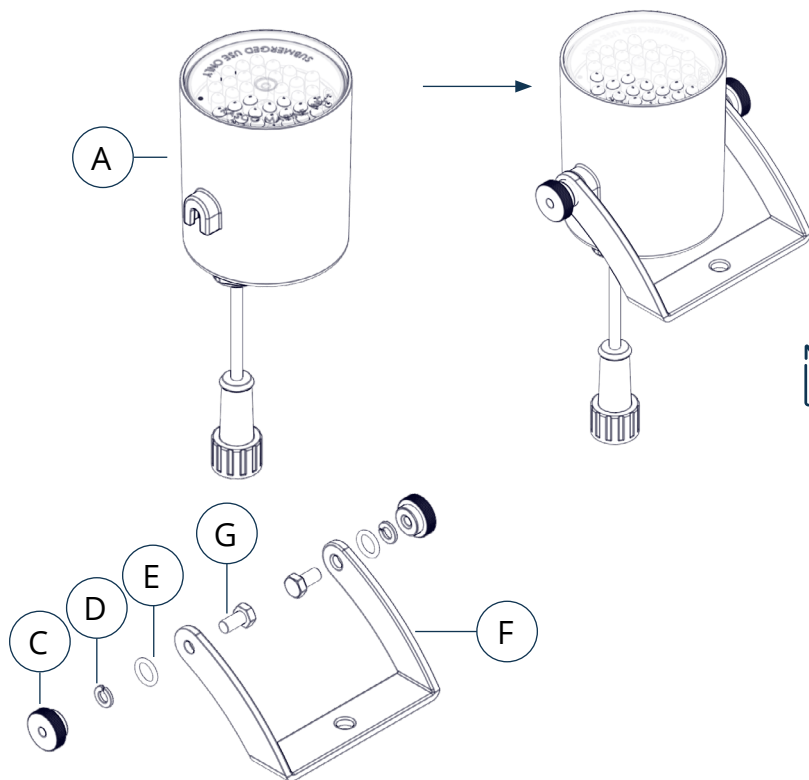

NOTE Determine whether the Universal mount bracket works better in a horizontal or vertical configuration for your application (see next page) before attaching the composite light bracket to the fixture. Some configurations require the composite light bracket to be flipped from what is pictured here.

2. Assemble parts H, I, J, and K as shown in Figure 4 to secure the fixture to the float and tighten until secure.
 - 7/16" socket and wrench required.

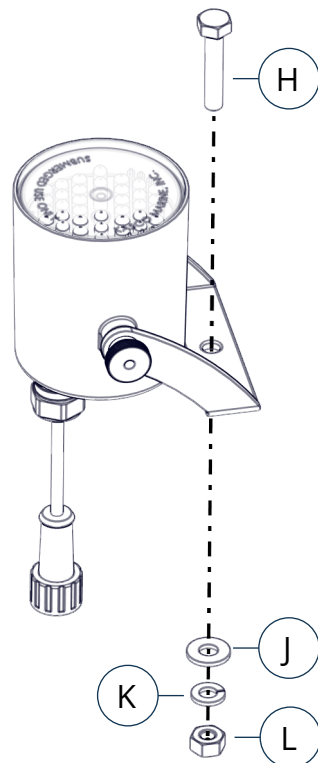

UNIVERSAL MOUNTING INSTRUCTIONS (CONT.)

Hardware is provided for basic installation. Check your installation to ensure you have the correct hardware. Additional hardware may be included, or you may need to purchase it if your installation varies from the diagrams below.

3. Use 1/4"-20 x 3/4" hex screws (O), flat washers (I), lock washers (J), and hex nut (K) as shown in Figure 5 to secure each Composite light brackets (F) to the Universal mounting brackets (M).

Use 1/4"-20 x 3/4" hex screws (Q), fender washers (P), lock washers (J), and hex nut (K) to secure the Universal bracket to the float.

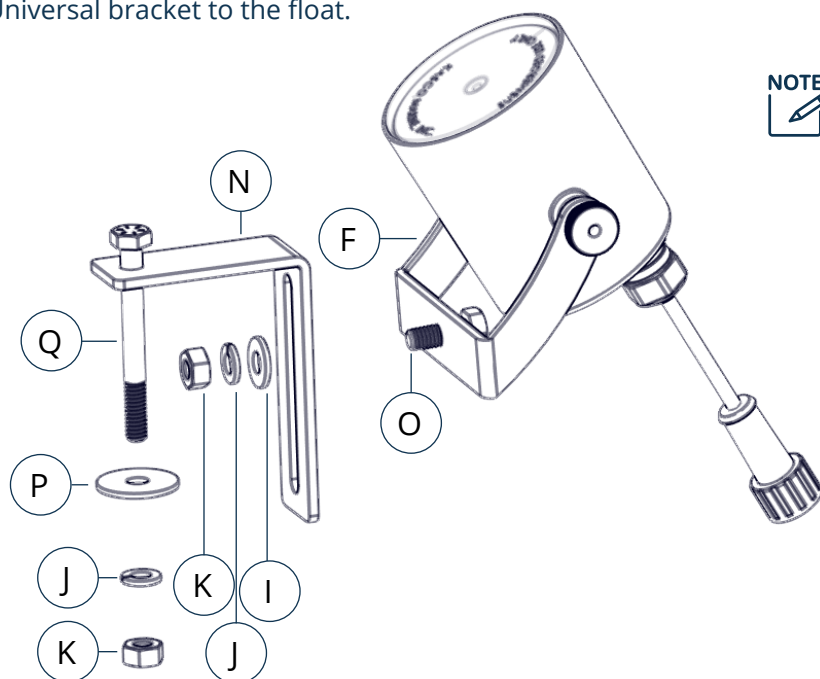

NOTE Note: Composite light bracket (H) needs to be flipped upside down for horizontal mounting.

4. Repeat for remaining fixtures, spacing evenly around the float. Adjust the angle of the lights using thumb nuts if desired, being sure to use the same angle for all fixtures. Cable ties can be used to attach the fixture cords to float, decrease play, and ensure protection. Cable-tie the light kit power cord to the float opposite the fountain power cord for balance and to prevent damage from the fountain. **Remember: RGBC5 fixtures MUST be properly submerged (approximately halfway) to avoid overheating.**

For vertical bracket mounting, use the hardware shown to fasten the two brackets together. Then use your existing float screws through the slot in the Universal bracket to secure it.

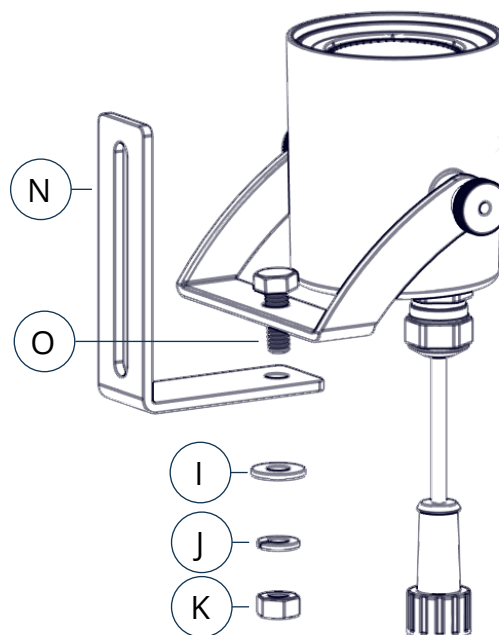

CONTROL PANEL INSTALLATION & OPERATION

1. Open the control box and remove the operating instruction sheet, remote control, and battery. Insert the battery into the remote control. If the battery is already inserted, remove the plastic battery guard from the remote to activate the battery connection.
2. The RGB control box is ready to mount next to your Kasco fountain control box (mount a minimum of 5ft from water) using two exterior-grade wood screws; one for the top and one for the bottom hanger. Tighten the top screw to prevent the box from lifting off the screws. Mount close enough for the power cord to reach the receptacle or terminals labeled "Lights" in the fountain control box.

NOTE Do NOT power on RGB control box at this time.

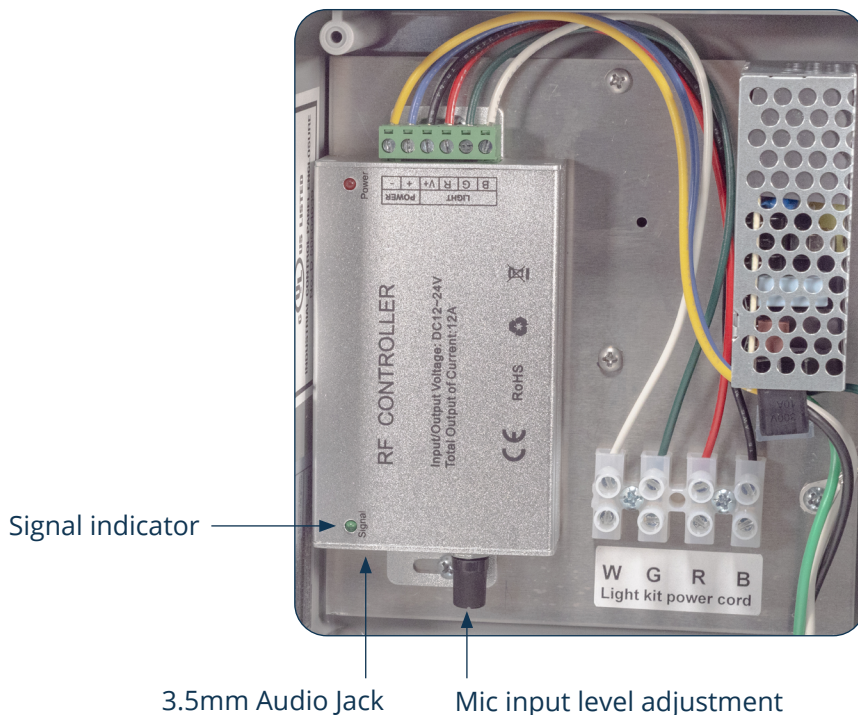

Connect light kit power cord wires to this terminal block.

3. Once mounted, connect the RGB light kit power cord to the field terminal connections in the RGB control box. Connect: White to White, Green to Green, Red to Red, and Black to Black.
4. For 120V fountain control box: Plug the RGB control box into the "Lights" receptacle in the fountain control box. This will allow the C-25 control panel to control the lights and the fountain through the timer. To energize the C-25 light receptacle, the photo-eye of the C-25 will need to be covered (to simulate nighttime conditions). Refer to your C-25 instructions.
For 240V or 3phase fountain control box: If you have a Kasco C-85, C-95 or 3phase control panel, you will need to hardwire the RGB controller power cord to the light terminals in your fountain control panel. Refer to your fountain owner's manual for connection information. The Kasco C-85, C-95, and 3phase control panels use a timer for controlling the light output. Ensure the light timer is set as required. Refer to your fountain owner's manual for timer setting instructions.
5. With the RGB controller door open, a red LED "Power" indicator on the RGB control module will be seen. If this indicator is not on, then power is not being sent to the RGB control box.
6. The RGB controller is operated with the included remote control. The controller will operate in the last mode set until it is changed with the remote. Before use, remove the clear plastic tab at the base of the remote. The figure on the next page details the remote control's functions. The green signal indicator (on the RGB controller) will flash while the remote is communicating to the controller.

CONTROL INPUT FEATURES

Music input control: The RGB controller is capable of changing colors based on sound input. The controller has a 3.5mm audio jack and a microphone built into the controller. The microphone input is adjustable with a level sensitivity dial.

The audio input jack is compatible with the headphone jack on a smartphone, MP3 player, or a pre-amp type output via an "aux" style 3.5mm connection. Do not connect to a line level (amplified speaker) output. Kasco recommends a 3.5mm "Y" adapter to allow for connection of the audio source to the RGB controller and a stereo amplifier simultaneously if desired.

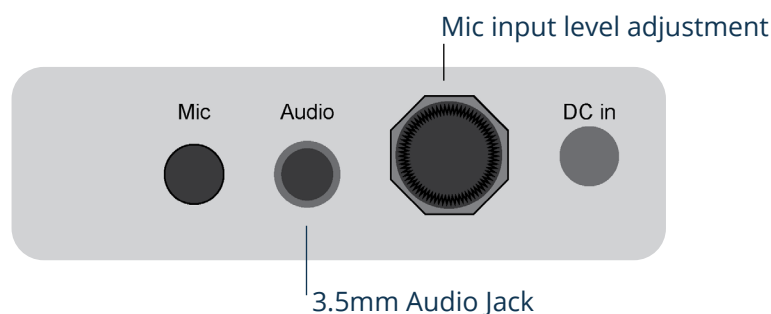

REMOTE CONTROL FEATURES

9 static color modes:

White, Red, Green, Blue, Warm White, Amber, Yellow, Cyan, Magenta.

- Repeatedly press the color to cycle the intensity from 100%, 50%, 25%, 12%, 6% and back to 100%.



Automatic color sequencing modes:

- Flash – jump to next color;
- Bloom- transition from color to color;
- Smooth – smooth transition from color to color

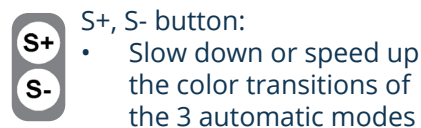
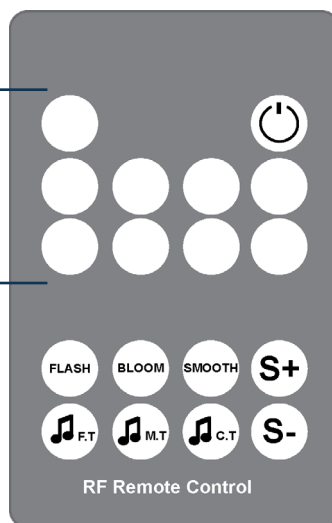

3 automatic music modes:

- FT – Fast track, color change is fast change
- MT – My track, color change is medium changing speed
- CT – Cool track, color change is slower and smoother than FT and MT.

MAINTENANCE RECOMMENDATIONS

Under NO CIRCUMSTANCE should anyone enter the water while a fountain is operating.

The following maintenance procedures can be utilized to ensure many years of quality performance from your Kasco fountain and light kit and reduce the need for more costly repair work.

Proper Installation

Proper installation of Kasco equipment will include a power source with ground fault protection. The control panel included with the equipment has built-in ground fault protection for both the fountain and the lighting kit. Ground fault interrupters are a safety feature that can also alert you to electrical leaks in the equipment. If you have repeat, consistent trips of the ground fault device, the equipment should be disconnected and removed from the water. The power cord should be inspected for damage and you should contact your distributor or contact Kasco Marine at 715-262-4488 or sales@kascomarine.com for further instructions. A complete list of control panels can be found in the Accessories section of kascomarine.com.

Observation

Operating equipment should be observed on a regular basis (daily, if possible) for any reduction or variation in performance. If a change in performance is observed, the equipment should be disconnected from power and inspected.

Winter Storage

In regions where there is significant freezing in the wintertime, the light kit should be removed from the water to protect it from the expansion pressure of ice. Storage over winter is best in a location that is out of the sun and cool, but above 32° F.

Cleaning

Light kits should be removed from the water at least once per year (at the end of the season in cold climates) to clean the exterior of the system. The light fixture surfaces dissipate heat into the water, and any algae, calcium, or other build-up will become an insulator that blocks heat transfer and may lead to overheating and damage. Keeping the lenses clean will also ensure the brightest light possible.

WARRANTY

Warranty Policy

Warranty period: RGB4C5 = 2 year Limited Warranty. Kasco® Marine, Inc. warrants this light kit to be free from defects in material or workmanship under normal use and service. The Kasco Marine, Inc. obligation under this warranty is limited to replacing or repairing free of charge any defective part within the warranty period from the date of shipment. Customer shall pay shipping charges for returning the unit to Kasco.

THIS WARRANTY IS IN LIEU OF ANY OTHER WARRANTIES, EXPRESSED OR IMPLIED, AND ANY OTHER OBLIGATION OR LIABILITY WHATEVER ON THE PART OF KASCO MARINE, INC. AND IN NO EVENT SHALL KASCO MARINE, INC. BE LIABLE FOR ANY SPECIAL OR CONSEQUENTIAL DAMAGES.

Warranty is void if:

- The light kit is not maintained properly according to the Maintenance Recommendations supplied in this Manual.
- The lights, control box, or power cord are altered in any way from original shipment. Cuts in the power cord are not covered under warranty.
- The light kit is damaged by unauthorized tampering.

Warranty Claim Procedure

The best method for establishing warranty period is by keeping your original receipt and registering the equipment online at kascomarine.com under the Warranty Information section.

Once warranty coverage has been established, the light kit may be sent to Kasco Marine or any Kasco Authorized Repair Center for evaluation and repair.

REPAIR

 **NOTE** The LED light fixtures are sealed and do not require any physical maintenance other than cleaning.

If a fixture fails to operate it can be removed and the included sealing cap installed onto the waterproof connector of the power cord. This will allow you to continue to operate your light kit with two fixtures while a replacement fixture is procured. Utilize caution when removing the shrink tube from the connector. Only perform this removal/replacement with all equipment disconnected from the power source.

Any required repairs must be performed by Kasco Marine. Any alterations or changes made to Kasco units by an unauthorized source will void the warranty. This includes tampering with the unit, power cord, and/or control box.

A physical Kasco Repair Form must be included with any equipment sent to Kasco or an Authorized Repair Center. This form can be found under the Support section of kascomarine.com. If no Repair Form is available, include your name and physical address for return delivery of the repaired light kit and a daytime phone number and/or e-mail address for correspondence regarding the warranty claim.

Note: Visually inspect the power cord for any cuts, rodent chews, etc. to determine if it should be included in the repair shipment. The cord may be needed by the shop to diagnose the failure.

Once warranty coverage has been established, the equipment may be sent to any Kasco Authorized Repair Center or to Kasco at the address listed on the repair form.

NON-WARRANTY REPAIRS

Most failed equipment can be repaired at substantially lower costs than replacement with new. If your light kit requires repair and is no longer covered under warranty, please contact Kasco Marine or your local distributor for available options. Please ship according to the instructions on the repair form.

- Kasco Marine does estimates on repairs at the request of the customer. The request for estimate should be included in the letter that accompanies the returned unit and must include a daytime phone number and/or e-mail address. We will contact the customer with a total after the unit has been evaluated, but before the work is performed.
- All estimates that are rejected for repair will be destroyed unless otherwise directed by the customer. Rejected equipment can be returned at the customer's expense for shipping and handling charges.

Billing:

All non-warranty repairs will be returned and billed to the customer unless otherwise directed. Kasco Marine accepts Visa and MasterCard credit card payments. Kasco Marine will call for credit card information upon completion of the estimate at the customer's request.

Please see the Support section of kascomarine.com for more information about warranty and repairs. Contact Kasco Marine at the number above or sales@kascomarine.com for additional information and your closest Authorized Repair Center.

CONTACT US



Kasco Marine
800 Deere Road
Prescott, WI 54021



715.262.4488



kascomarine.com | sales@kascomarine.com

REPAIR CONTACT FORM

- Kasco requires that all equipment sent for repair MUST be accompanied by this form and marked to Repairs attention.
- Unit should be cleaned before shipping.
- Kasco is NOT responsible for shipping damage accrued in return shipment.
- It is the responsibility of the customer to ship and pay freight to Kasco.

Kasco Marine
800 Deere Road
Prescott, WI 54021
Attn: Repairs

Note: Contact information should be that of the person or company to contact for repair information.

Company name			
Contact name	First name	Last name	
Address	Street		
	City		
	State		
	ZIP code		
Phone number	Primary	Alternate	
Email address			
Preferred method of contact (circle one)	Phone	Email	
Purchase order number			
Additional product information	Serial Number	Cord Length	
Information for Repair Technician			
Was this unit used in a chemical treatment or wastewater application? (circle one)		Yes	No
Additional notes			